



# 2024 Additional Branding Opportunities

Branding & Signage

# Lobby Tall Banner Branding

\$1,500 Each Atrium Banner

F2, F3, F4, F5, F6, F7, F9, F10

Dimensions: 42.5 in wide x 225 in tall



Atlanta Braves Banners

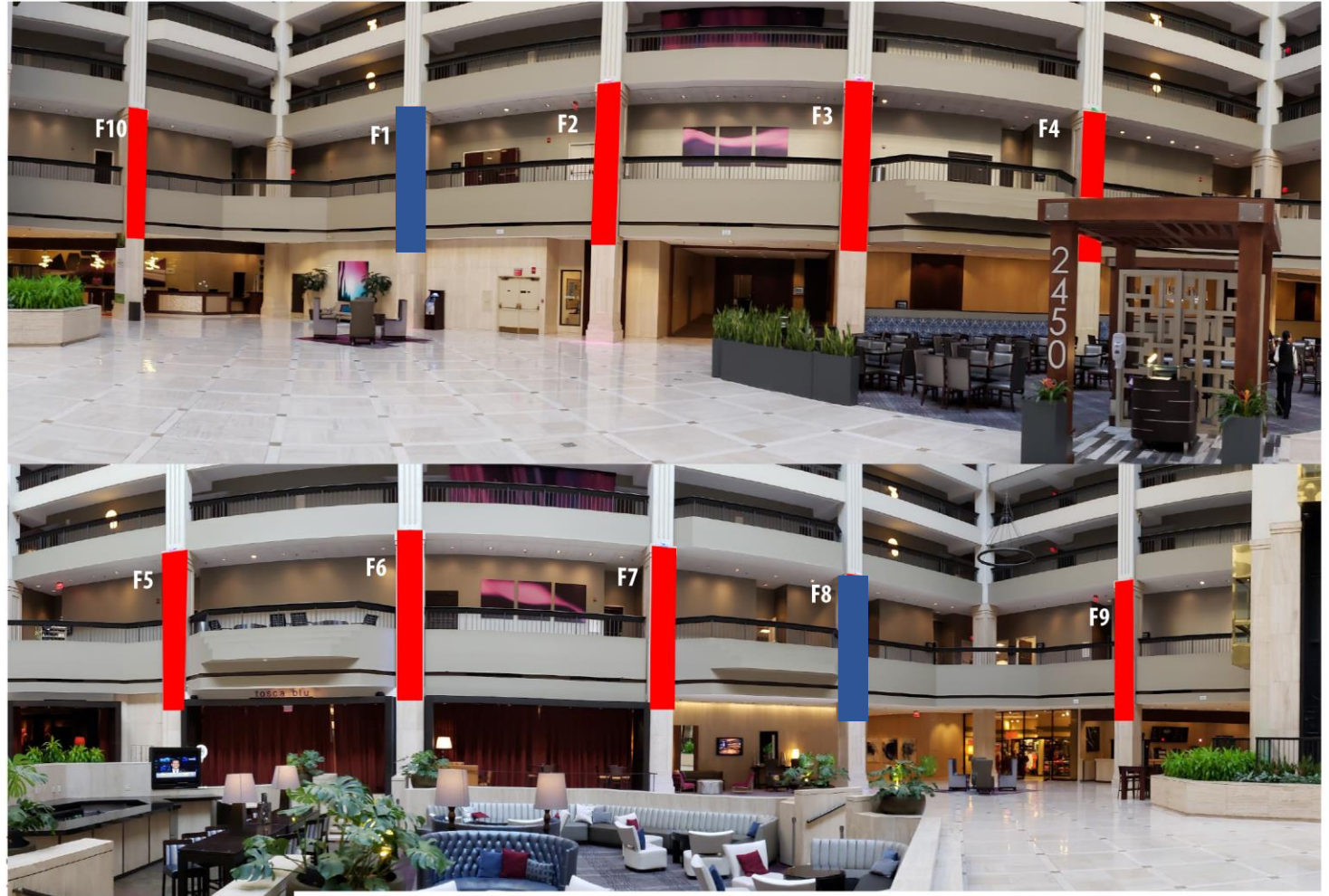
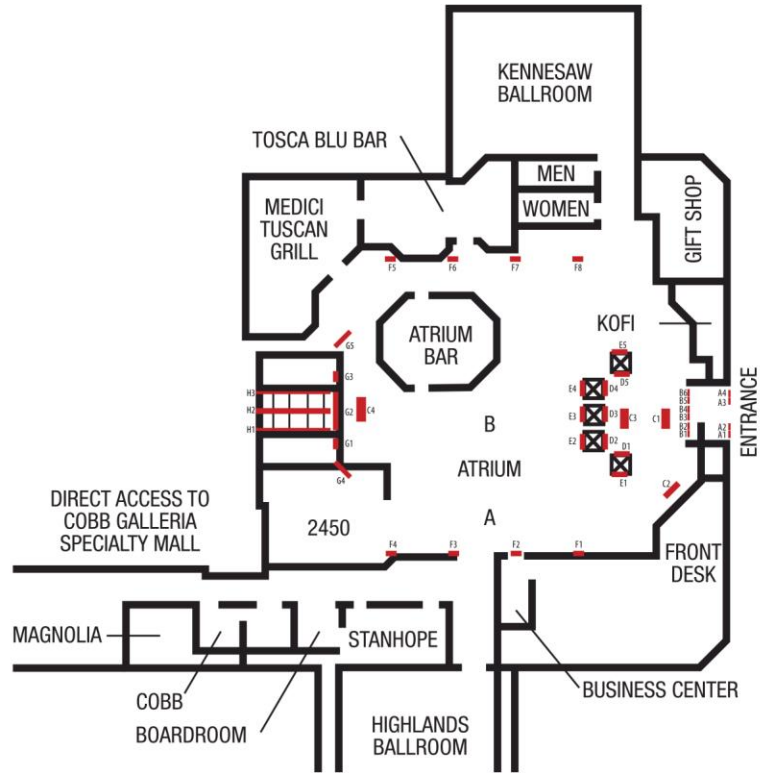

# Lobby Level Branding

\$1,500 Each Floor Decal

C1,C2,C3,C4

Dimensions: 8' wide x 3' tall

\$1,500 Each Atrium Balcony Banner

G4, G5

Dimensions: 120in wide x 54in tall

 Co-Branded with Presenting Sponsor

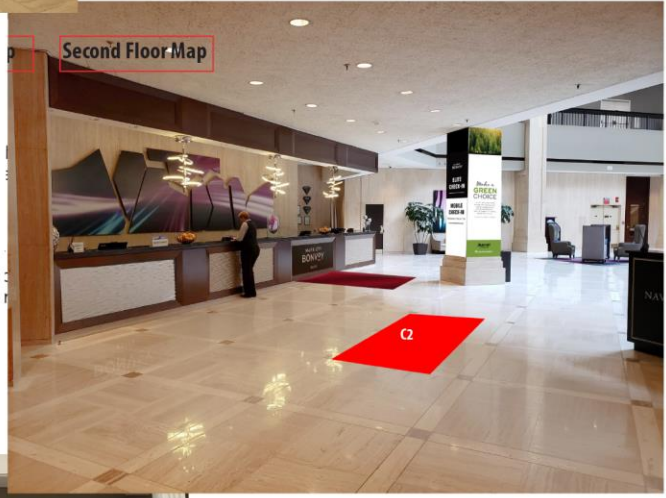
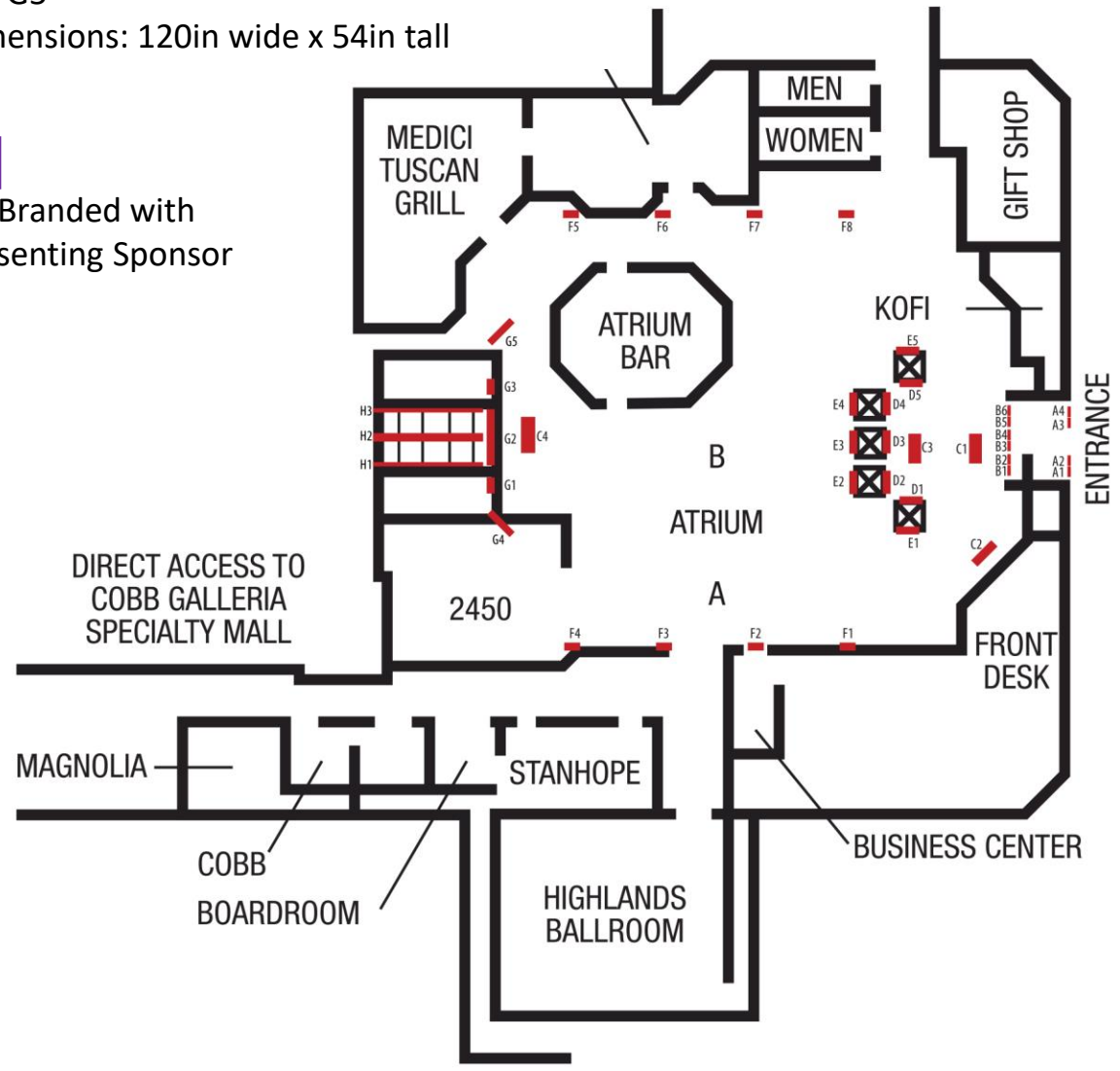

## Lobby Elevator Branding:



\$1,500 per Elevator Door Graphic

D1, D2, D3, D4, D5

Dimension Detail:

Total wrap size is 40in wide x 108in tall

Area above doors is 40in wide x 24in tall

Each of two doors is 20in wide x 84in tall

## Elevator Atrium Glass Graphics:

\$850 per Elevator TOP Window Graphic

E1T, E2T, E3T, E4T, E5T

Dimensions: 48in x 48in

\$850 per Elevator BOTTOM Window Graphic

E1B, E2B, E3B, E4B, E5B

Dimensions: 62.5in wide x 24in tall



Bar/Coffee/Restroom Side

Front Desk side



# Garden Atrium Branding

## Above Doors – Each Panel

\$1,000 Registration/SECO Hub Windows

P1,P2,P3,P4,P5,P6

\$1,500 Manufactured Home Branding

M1

\$1,000 SECO Ballroom

N4, N5,N6,N7



\$1000 Exhibit & Dining Space

N1, N2

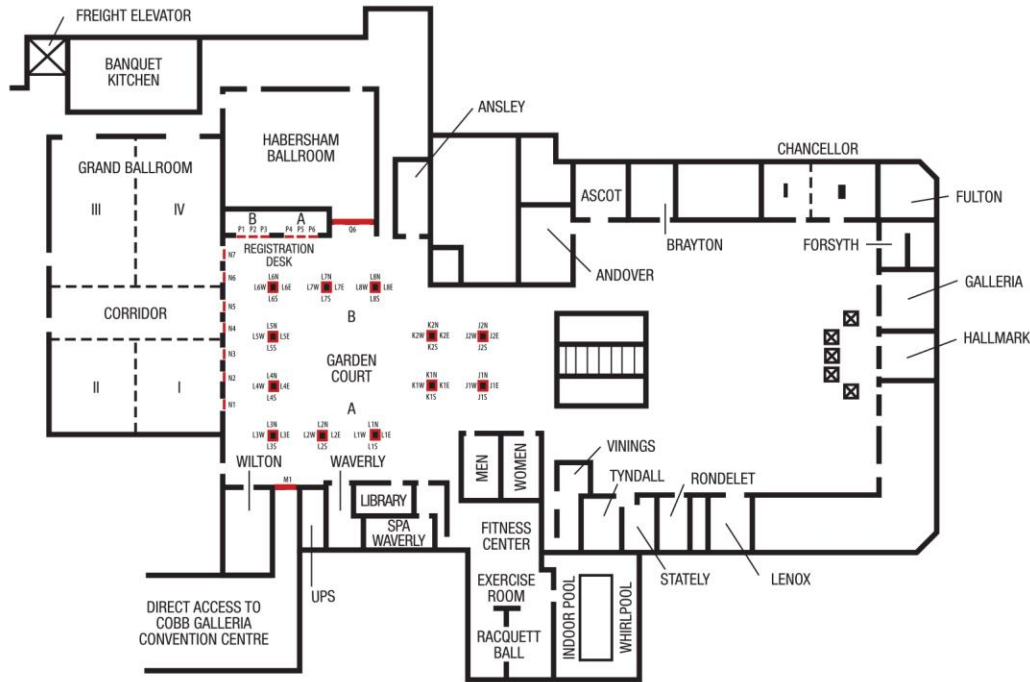

Columns – J1 – L8

\$750 per side

\$2,000 all four sides

Dimensions:32.5in wide x 85in tall

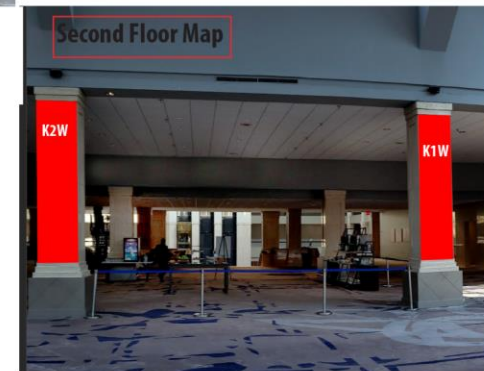

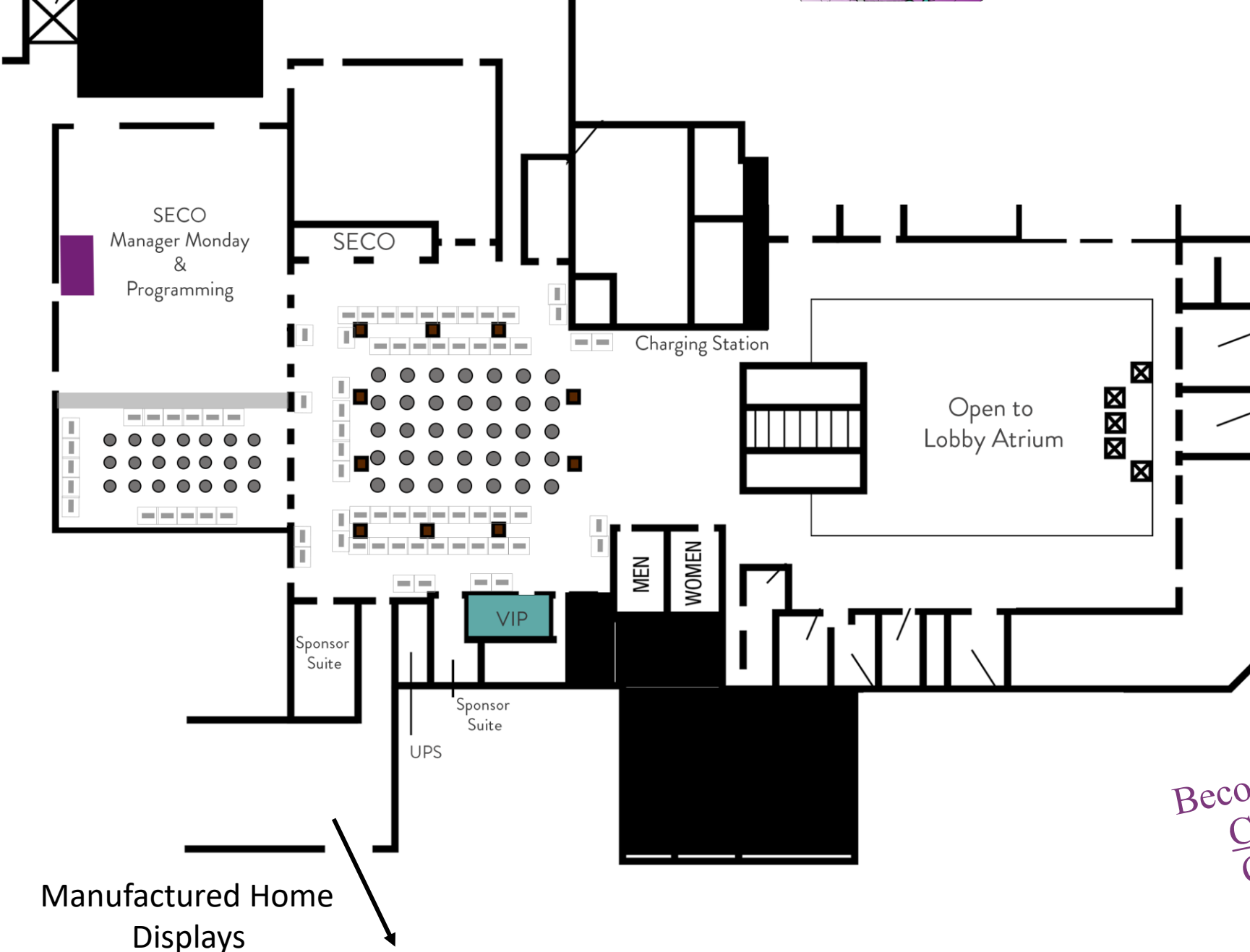

**SECO**  
 NATIONAL CONFERENCE OF  
 COMMUNITY OWNERS  
*For Community Owners, By Community Owners*

2024  
 Waverly Renaissance  
 Hotel & Conference Center

*Become A SECO 2024 Sponsor Today  
 Contact@SECOconference.com  
 Or you may call/text Kristin  
 770-378-8408*

# Additional opportunities for your brand to stand out!

| <b>DURING SECO 2024 Parntership Opportunities</b>                                       | <b>Additional Cost</b> | <b>Partner Perks</b>  |
|---|------------------------|---|
| Welcome Reception Host on Monday 9.16   | \$17,000.00            | 2 VIP badges, additional branding oppourtunities, logo on web page, 1 dedicated email, list of attendees                                |
| DJ Entertainment, Appetizer Displays, 2 Drink Tickets, Announce Golf Tournament Winners |                        |   |
| Happy Hour Mixer on Tuesday 9.17  | \$15,000.00            |   |
| Entertainment, Appetizer Displays, 2 Drink Tickets                                      |                        |   |
| Wednesday Manufactured Home Display Reception   | please contact         | 2 VIP badges, additional branding opportunities, logo on web page, 1 dedicated email, list of attendees                                 |
| Entertainment, Heavy Appetizers, 2 Drink Tickets  |                        |   |
| Tuesday's Kick-Off  | \$10,000.00            | 2 VIP badges, dedicated 5 minutes of speaking time pre or post keynote speaker, 1 dedicated email, list of attendees                    |
| SECO contracted talent, equipment, & materials  |                        | Badges for one leader and one brand rep. Additional badges are \$474 each   |
| Meal Sponsorships:  |                        |   |
| Monday - Manager Monday Boxed Lunch   | \$3,000.00             | Logo on main stage during meal, speaking time from main stage during meal, Signage on buffets, website logo, & social posts and stories |
| Tuesday Breakfast   | \$3,000.00             | Logo on main stage during meal, speaking time from main stage during meal, Signage on buffets, website logo, & social posts and stories |
| Tuesday Lunch   | \$5,000.00             | Logo on main stage during meal, speaking time from main stage during meal, Signage on buffets, website logo, & social posts and stories |
| Tuesday Afternoon Break   | \$2,500.00             | Logo on main stage during meal, speaking time from main stage during meal, Signage on buffets, website logo, & social posts and stories |
| Wednesday Breakfast   | \$3,000.00             | Logo on main stage during meal, speaking time from main stage during meal, Signage on buffets, website logo, & social posts and stories |
| Wednesday Lunch   | \$5,000.00             | Logo on main stage during meal, speaking time from main stage during meal, Signage on buffets, website logo, & social posts and stories |
| Wednesday Afternoon Break   | \$2,500.00             | Logo on main stage during meal, speaking time from main stage during meal, Signage on buffets, website logo, & social posts and stories |
| Thursday Contintental Breakfast   | \$2,000.00             | Logo on main stage during meal, speaking time from main stage during meal, Signage on buffets, website logo, & social posts and stories |
| VIP Lounge Takeover   | \$3,000.00             | Logo on website and onsite in lounge  |
| Charging Stations, located in Garden Atrium   | \$2,500.00             | Logo on website and onsite signage  |
| Wireless Internet for all attendees   | \$3,500.00             | Logo on website and onsite signage  |
| <b>ON-Site Exhibitors ONLY Opportunities</b>  |                        |   |
| Banner Display in Main Hotel Lobby F2 - F10   | \$1,500.00             | A banner hanging in a prominent location, reaching 24' high in the main hotel lobby atrium.   |
| Floor Graphic on Lobby Level C1, C2, C3, C4   | \$1,500.00             | Several oppourtunities for attendees to see your brand at their feet.   |
| Eleveator DOOR Graphics D1, D2, D3, D4, D5  | \$1,500.00             | While attendees are waiting for the elevator, your brand greets them everytime.   |
| Elevator GLASS Graphics E1, E2, E3, E4, E5 TOP  | \$1,200.00             | Displayed on the grand elevators, TOP of hand bar, your brand becomes a visual for all to see.  |
| Elevator GLASS Graphics E1, E2, E3, E4, E5 BOTTOM                                       | \$1,200.00             | Displayed on the grand elevators, BOTTOM of hand bar, your brand becomes a visual for all to see.                                       |
| Vinyl Banners on each side of atrium G4 & G5  | \$1,500.00             | Displayed on the grand Atrium ESCALATORS, your brand becomes a visual for all to see.   |
| Center Staircase Railing H2   | \$1,500.00             | Displayed on the grand Atrium ESCALATORS, your brand becomes a visual for all to see.   |
| Staircase Railing H1 & H3   | \$1,000.00             | Displayed on the grand Atrium ESCALATORS, your brand becomes a visual for all to see.   |
| Garden Atrium Columns J1-L8 per side  | \$750.00               | Displayed IN the GARDEN Atrium  |
| Garden Atrium Columns J1-L8 all four sides  | \$2,000.00             | Displayed IN the GARDEN Atrium  |
| Branding Insert for above registration - P1-6   | \$1,000.00             | Displayed IN the GARDEN Atruim  |
| Branding Insert for above doors - MH Displays M1  | \$1,500.00             | Displayed IN the GARDEN Atruim  |
| Branding Insert for above doors - exhibits N1 & N2                                      | \$2,000.00             | Displayed IN the GARDEN Atruim  |
| Branding Insert for above doors - SECO Program N3                                       | \$2,500.00             | Displayed IN the GARDEN Atrium  |
| Lanyard Sponsorship - Your Logo on our Lanyard  | \$3,500.00             | High visual oppourtunity, this co logo oppourtunity will be seen by everyone for years to come in all photos.                           |
| Room Key Cards  | \$3,000.00             | This is a chance for the very first impression - welcome all guests to the hotel.   |
| Swag Bag Insert   | \$1,000.00             | Great optics for your brand message, keep your brand infront of attendees by providing useful items.                                    |
| Additional Email with Sponsor Message   | \$1,000.00             | Have a message you would like our attendees to see and hear? We can send out an additional message on your behalf.                      |

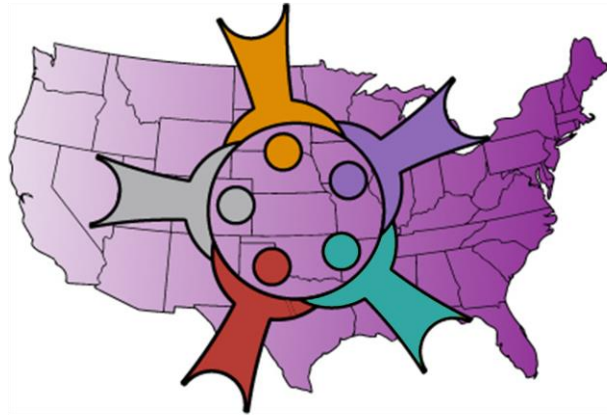

**SECO** 501(c)(3)

**NATIONAL CONFERENCE OF  
COMMUNITY OWNERS**

*For Community Owners, By Community Owners*

# Ready to join us?

Please email us at

[contact@SECOconference.com](mailto:contact@SECOconference.com)

Or you may call/text Kristin

770-378-8408